

374_60

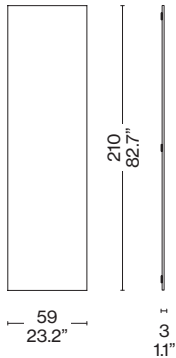

374_90

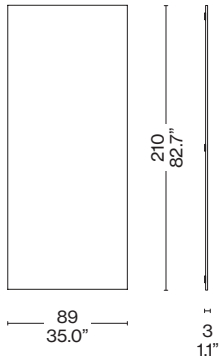

374_60

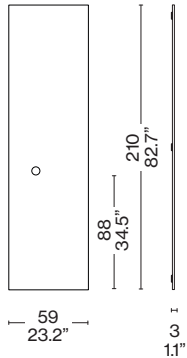

374_90

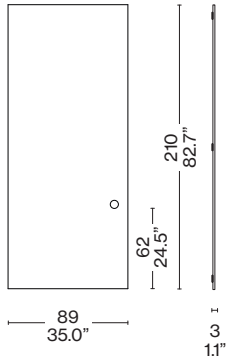

374 R1

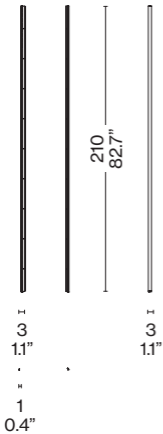

374 R2

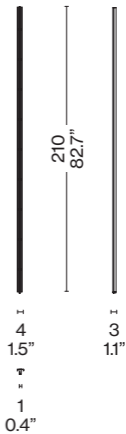

374 60 F2/A2

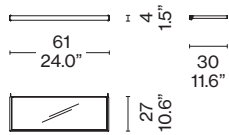

374 90 F2/A2

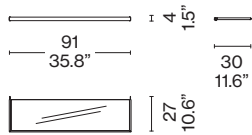

374 60 F3/A3

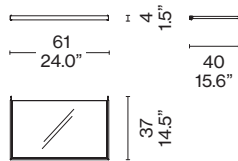

374 90 F3/A3

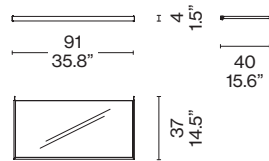

374 HF/HA

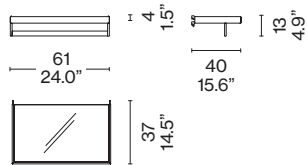

374 C1 60

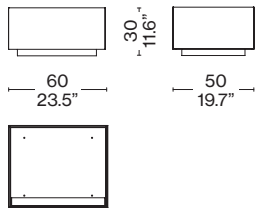

374 S1 60

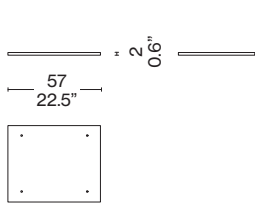

374 C1 90

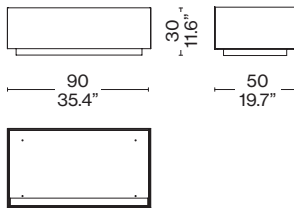

374 S1 90

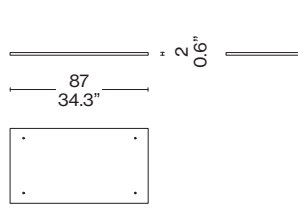

374 C2 60

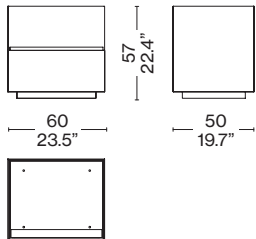

374 C2 90

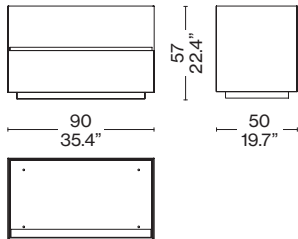

374 60 V_/M_

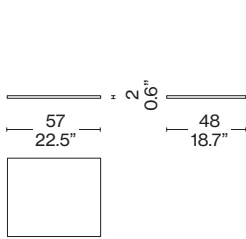

374 90 V_/M_

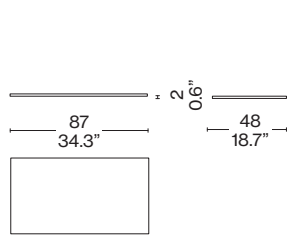

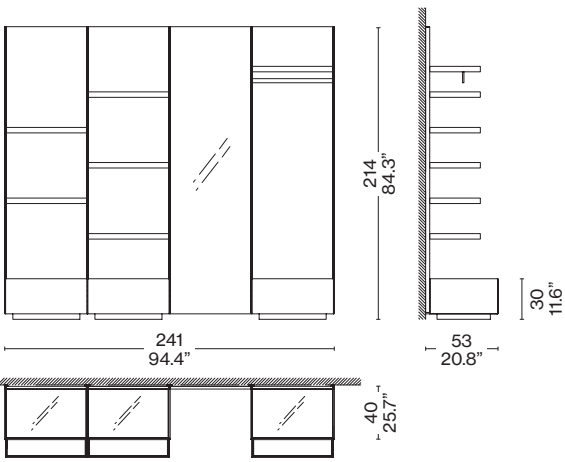

- 3 x 374 __60
- 1 x 374 SP 60
- 1 x 374 R2
- 3 x 374 R1
- 3 x 374 K1
- 5 x 374 60 _3
- 1 x 374 H_
- 3 x 374 C1 60
- 3 x 374 60 V_/M_

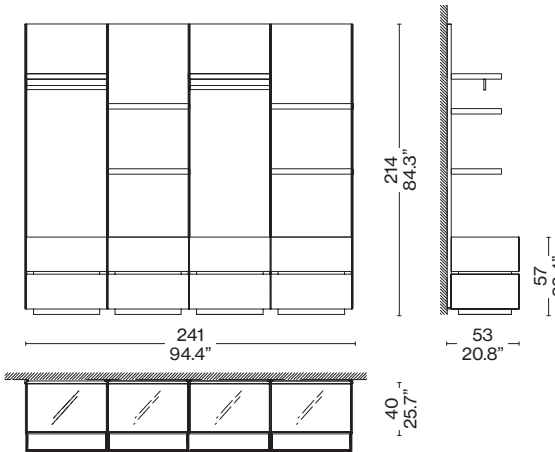

- 4 x 374 __60
- 1 x 374 R2
- 3 x 374 R1
- 4 x 374 K1
- 4 x 374 60 _3
- 2 x 374 H_
- 8 x 374 C1 60
- 4 x 374 S1 60
- 4 x 374 60 V_/M_

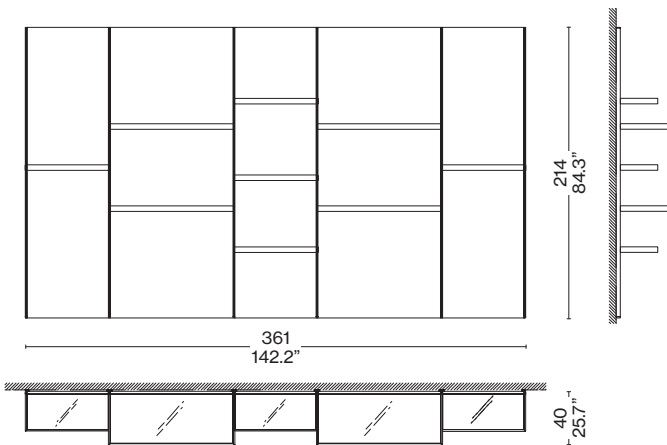

- 3 x 374 __60
- 2 x 374 __90
- 1 x 374 R2
- 4 x 374 R1
- 5 x 374 K1
- 4 x 374 90 _3
- 5 x 374 60 _3

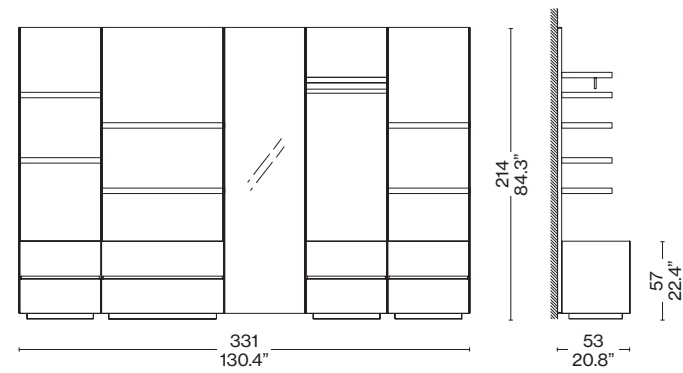

- 1 x 374 SP 60
- 3 x 374 _ 60
- 1 x 374 _ 90
- 1 x 374 R2
- 4 x 374 R1
- 4 x 374 K1
- 2 x 374 60 _3
- 2 x 374 90 _3
- 2 x 374 60 _2
- 1 x 374 60 H_
- 3 x 374 C2 60
- 3 x 374 60 V_/M_
- 1 x 374 C2 90
- 1 x 374 90 V_/M_

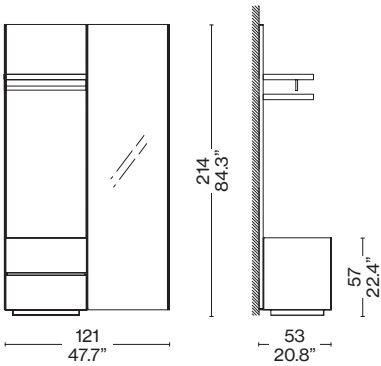
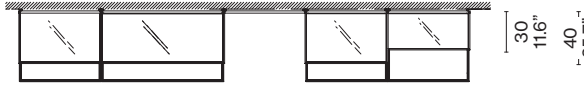

- 1 x 374 SP 60
- 1 x 374 _ 60
- 1 x 374 R2
- 1 x 374 R1
- 2 x 374 K1
- 1 x 374 60 H_
- 1 x 374 C2 60
- 1 x 374 60 V_/M_

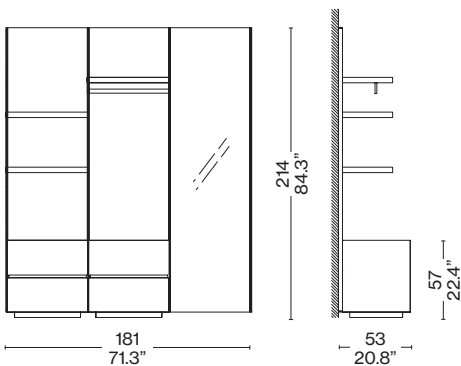
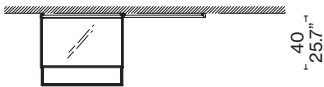

- 1 x 374 SP 60
- 2 x 374 _ 60
- 1 x 374 R2
- 2 x 374 R1
- 3 x 374 K1
- 1 x 374 60 H_
- 2 x 374 60 _3
- 2 x 374 C2 60
- 2 x 374 60 V_/M_

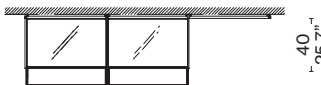

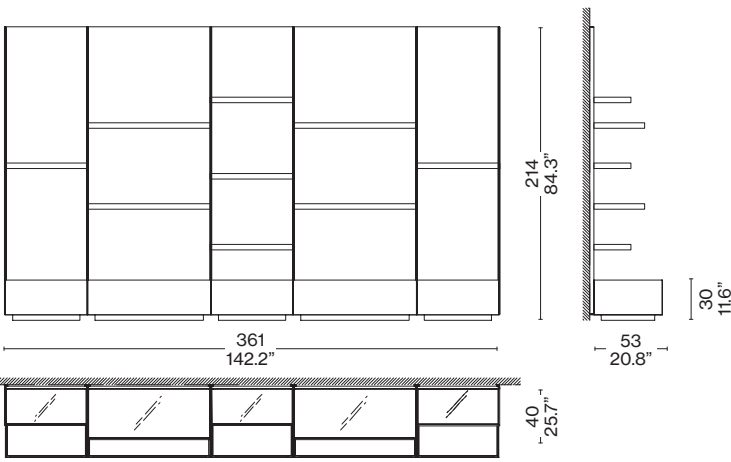

- 2 x 374 _ 90
- 3 x 374 _ 60
- 1 x 374 R2
- 4 x 374 R1
- 5 x 374 K1
- 4 x 374 90 _ 3
- 5 x 374 60 _ 2
- 2 x 374 C1 90
- 3 x 374 C1 60
- 2 x 374 90 V_/M_
- 3 x 374 60 V_/M_

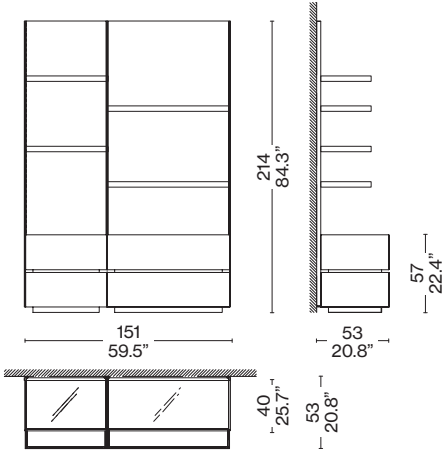

- 1 x 374 _ 90
- 1 x 374 _ 60
- 1 x 374 R2
- 1 x 374 R1
- 2 x 374 K1
- 2 x 374 90 _ 3
- 2 x 374 60 _ 3
- 2 x 374 C1 90
- 1 x 374 S1 90
- 2 x 374 C1 60
- 1 x 374 S1 60
- 1 x 374 90 V_/M_
- 1 x 374 60 V_/M_

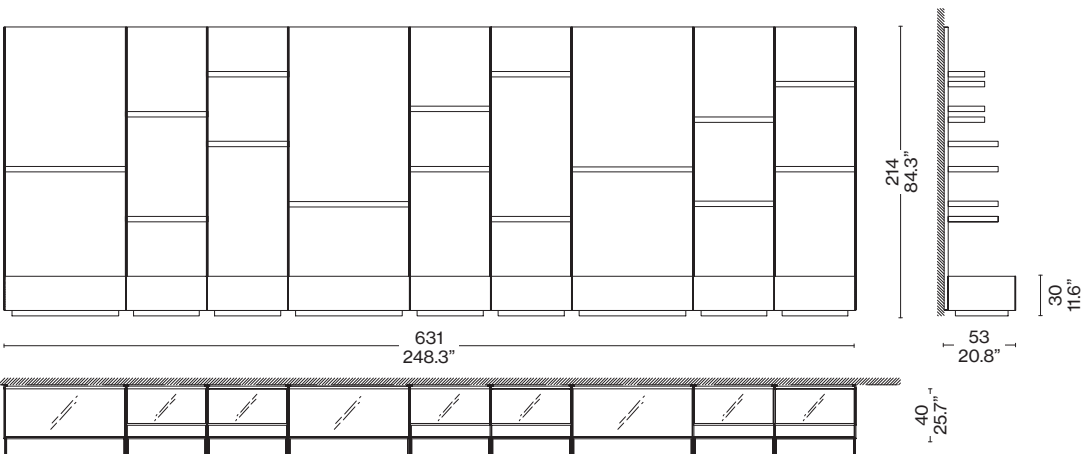

- 3 x 374 _ 90
- 6 x 374 _ 60
- 1 x 374 R2
- 8 x 374 R1
- 9 x 374 K1
- 3 x 374 90 _ 3
- 6 x 374 60 _ 3
- 6 x 374 60 _ 2
- 3 x 374 C1 90
- 6 x 374 C1 60
- 3 x 374 90 V_/M_
- 6 x 374 60 V_/M_

374 L6 27 + 374 F2 27

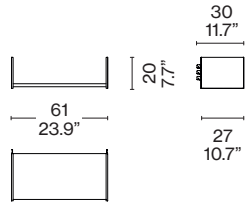

374 L6 37 + 374 F2 37

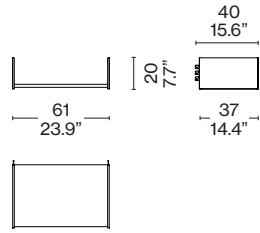

374 L9 27 + 374 F2 27

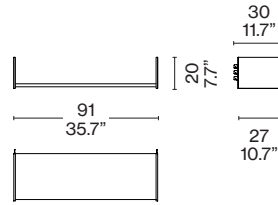

374 L9 37 + 374 F2 37

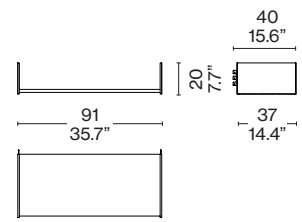

2 x 374 L6 27 + 374 F2 27 + 374 F1 27

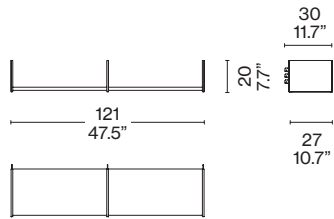

2 x 374 L6 27 + 374 P2 27

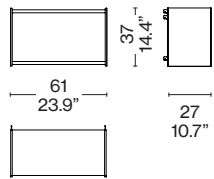

2 x 374 L6 37 + 374 P2 37

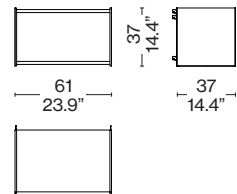

2 x 374 L9 27 + 374 P2 27

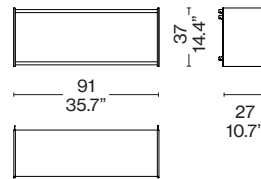

2x 374 L9 37 + 374 P2 37

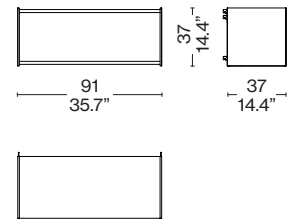

4 x 374 L6 27 + 374 P2 27 + 374 P1 27

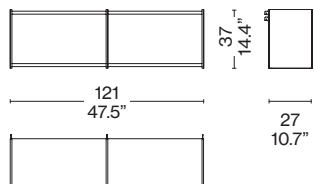

374 D6 01 + 374 F0 D0
+ 374 F0 S0

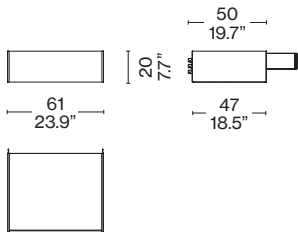

374 S9 00 + 374 S0 D0
+ 374 S0 S0

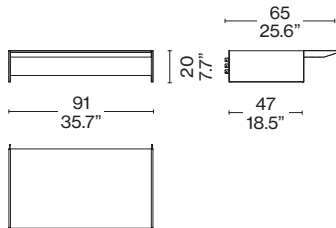

374 D6 V/M_

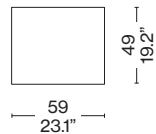

374 D9 V/M_

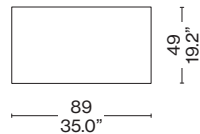

374 D9 01 + 374 F0 D0
+ 374 F0 S0

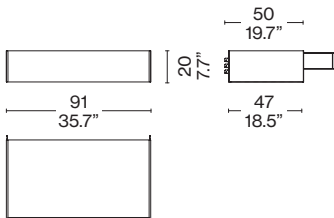

2 x 374 D6 01 + 2 x 374 D6 V/M_
+ 374 F0 D0 + 374 F0 S0 + 374 F0 10

